

Koala 140 AF



ATP









Refrigerated container for the transport of food/pharmaceutical products at a controlled temperature

- Available in versions:
 - AF: temperature adjustment range: from -30°C to +10°C;
 - AFH: with heating kit and temperature adjustment range: from -30°C to +40°.
- Insulation offered by container walls ensures that the temperature maintenance is guaranteed with a minimum number of ignitions of the cooling unit; this contributes limiting energy consumption.
- Cooling unit is triggered when inner temperature is higher than the temperature set with the programmable digital thermostat. This allows to maintain a constant temperature even in case of very high external temperatures.
- In the AFH versions, the heating unit is triggered when inner temperature is lower than the temperature set with the programmable digital thermostat. This allows to maintain a constant temperature even in case of very low external temperatures.
- Total compliance with the cold chain at all stages of transport.
- It can be transported using conventional vehicles: it allows to simultaneously transport chilled, frozen and ambient temperature products using a single non-insulated vehicle.
- Dual power source: during transport can be connected to the battery (or auxiliary battery) of the vehicle and, at the destination, can be connected to mains power.
- Manufactured using the rotational moulding technology: mono-block container and door (free of sharp edges, joints and welds).
- Fully recyclable at the end of the operating life.

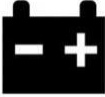
MANUFACTURING MATERIALS

Polyethylene	inner and outer walls of the container and lid; suitable for food contact	Polyurethane	insulating material between the walls of the container and of the lid; free of CFC and HCFC
Silicone	gasket	Polyamide and fiberglass	clasp
Stainless steel	grip handles	Aluminum	Cooling unit frame and hinge

TECHNICAL CHARACTERISTICS

<p>AF version</p>	<ul style="list-style-type: none"> • from 0°C to +10°C • from -18°C to +10°C • from -25°C to +10°C • from -30°C to +10°C 	<p>AFH version</p>	<ul style="list-style-type: none"> • from 0°C to +40°C • from -18°C to +40°C • from -25°C to +40°C • from -30°C to +40°C
<p>+/- 0,5 °C</p>	<p>Degree of accuracy in temperature adjustment:</p> <ul style="list-style-type: none"> • +/-0,5 °C 		<p>Protection against voltage drops of the vehicle battery, in case of falling below of the limit value of 11V</p>
	<p>Equipped with three cables:</p> <p>for power supply to 230Vac 50-60Hz</p>		<p>For power supply to 12Vdc</p> <ul style="list-style-type: none"> • with Anderson connectors
	<p>For power supply to 12Vdc</p> <ul style="list-style-type: none"> • with Anderson terminal for connection to the Koala and with cigarette lighter plug on the other end of the cable • with Anderson terminal for connection to the Koala and fork terminals for connection to the battery of the vehicle <p>(depending on the versions, see table in technical data for detailed information)</p>		<ul style="list-style-type: none"> • Cooling unit performance guaranteed for use at ambient temperature: from +10°C to +30°C • Container (insulated case) guaranteed for use: from -30° to +100°C
<p>GAS</p>	<p>Coolant gas:</p> <ul style="list-style-type: none"> • R134a (version 0°C +10/+40°C) • R452A (versions -18°C +10/+40°C -25°C +10/+40°C -30°C +10/+40°C) 		<p>Adjustment and control of the temperature with programmable digital thermostat</p>
	<p>Cooling unit equipped with a "roll-bond" static evaporator</p>		<p>Integrated stainless steel handles</p>
	<p>Closing hooks in shockproof material</p>		<p>Easily removable door seal</p>
	<p>Equipped with opening door up to 240 ° and easily removable, to facilitate washing operations</p>		<p>5 seats to house grids located at 62/152/242/332/422 mm from the base of the container. Grids available on request</p>
	<p>Monolithic structure, no sharp corners, junctions and welds</p>		<p>Stainless steel grid for load allocation, available upon request</p>
	<p>Insulated with CFC and HCFC-free polyurethane foam</p>		<p>Stainless steel interlocking kit available to interlock two stacked containers</p>
<p>K</p>	<p>Heat transfer global coefficient: K=0.35 W/m2K</p>		<p>USB data logger available (on request) to record temperature data during transport</p>

TECHNICAL SPECIFICATIONS

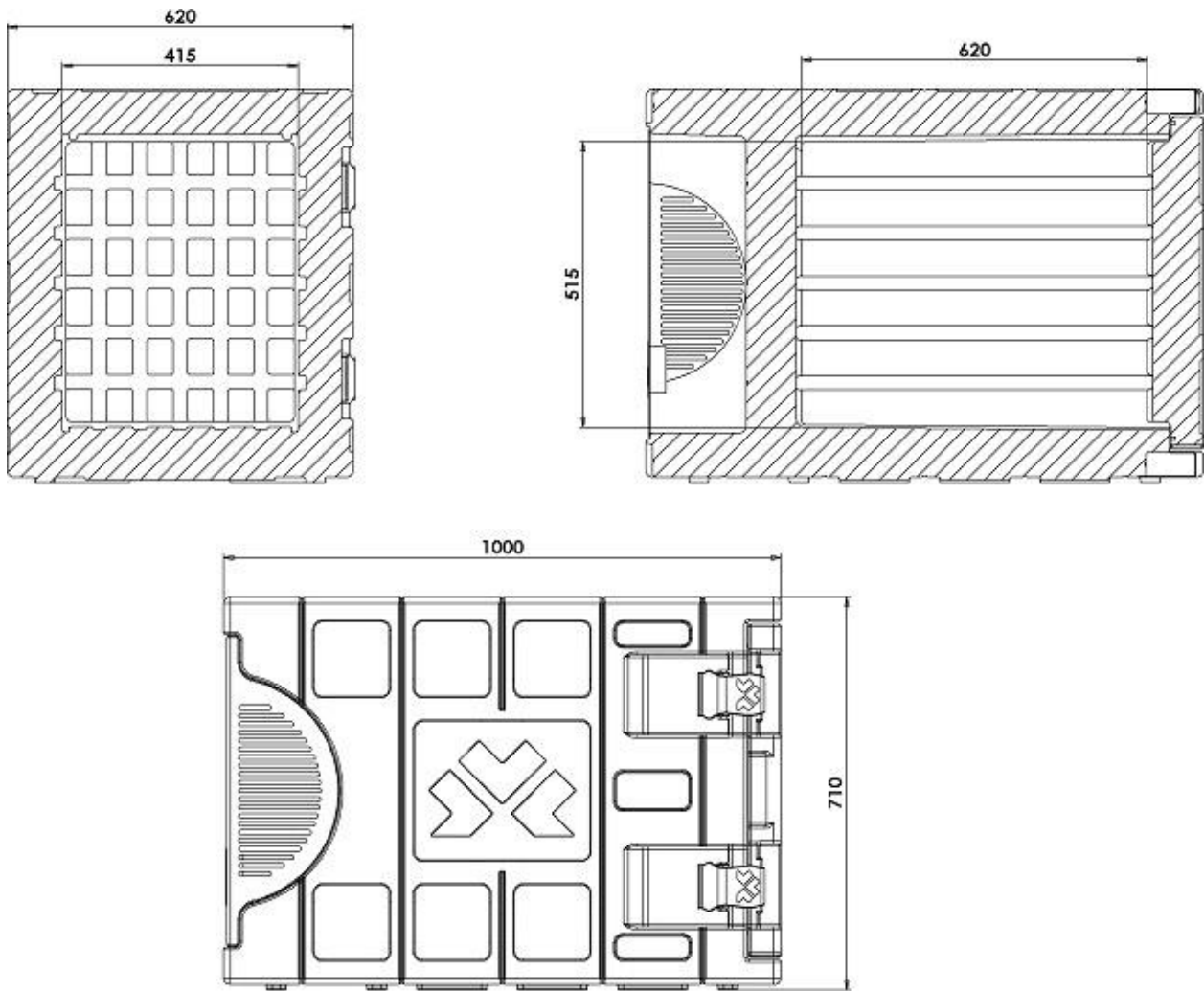

Model	Code	12V power supply Fork terminal	12V power supply Cigarette lighter socket	Nominal absorption	Fuses
AF VERSION					
Koala 140 AF from 0°C to +10°C	K140AFISDYM0		✓	0,35A to 230Vac 7A to 12Vdc	4A for 230Vac 15A for 12Vdc
Koala 140 AF from -18°C to +10°C	K140AFISCYM0	✓		1A to 230Vac 18A to 12Vdc	4A for 230Vac 30A for 12Vdc
Koala 140 AF from -25°C to +10°C	K140AFISBYM0	✓		1A to 230Vac 18A to 12V dc	4A for 230Vac 30A for 12Vdc
Koala 140 AF from -30°C to +10°C	K140AFISAYM0	✓		1A to 230Vac 18A to 12Vdc	4A for 230Vac 30A for 12Vdc

Model	Code	12V power supply Fork terminal	12V power supply Cigarette lighter socket	Nominal absorption	Fuses
AFH VERSION (with heating kit)					
Koala 140 AFH from 0°C to +40°C	K140AFISDZM0		✓	0,35A to 230Vac 7A to 12Vdc	4A for 230Vac 15A for 12Vdc
Koala 140 AFH from -18°C to +40°C	K140AFISCZM0	✓		1A to 230Vac 18A to 12V dc	4A for 230Vac 30A for 12V dc
Koala 140 AFH from -25°C to +40°C	K140AFISBZM0	✓		1A to 230Vac 18A to 12V dc	4A for 230Vac 30A for 12V dc
Koala 140 AFH from -30°C to +40°C	K140AFISAZM0	✓		1A to 230Vac 18A to 12V dc	4A for 230Vac 30A for 12V dc

Model	Code	Colour	External dim. (mm)	Internal dim. (mm)	Capacity l	Weight Kg
Koala 140 AF/AFH		melange grey blue	620x1000xh710	415x620xh515	135	46
ACCESSORIES						
Grid in stainless steel	AEA030	stainless steel	425x620xh12			2
Trolley in galvanized steel	AIB005	galvanized steel				8
Locking kit - 2 latches -	RRI137					1,2



Via Savigliano 34 - 12030 Monasterolo di Savigliano (CN)
 Tel. +39 0172812600 - Fax +39 017285991 - info@melform.com
 GPS: Lat 44.681363 - Long 7.624809

www.melform.com

E01e29fb11b4202a36fe04c871b195efa69b5075d2bfc7ea99b56c77a15b6c0b